

UNIT, DIRECT SUPPORT, AND GENERAL SUPPORT MAINTENANCE
REPAIR PARTS AND SPECIAL TOOLS LIST

EXTENDED SERVICE PROGRAM (ESP)

TRUCK, CARGO, 2-1/2-TON, 6X6, M44A3 SERIES TRUCKS (DIESEL)

M35A3, W/O WINCH (NSN 2320-01-383-2047); W/WINCH (NSN 2320-01-383-3850);

M35A3C, W/O WINCH (NSN 2320-01-383-2050); W/WINCH (NSN 2320-01-383-2049);

M36A3, W/O WINCH (NSN 2320-01-383-2048); W/WINCH (NSN 2320-01-383-2046).

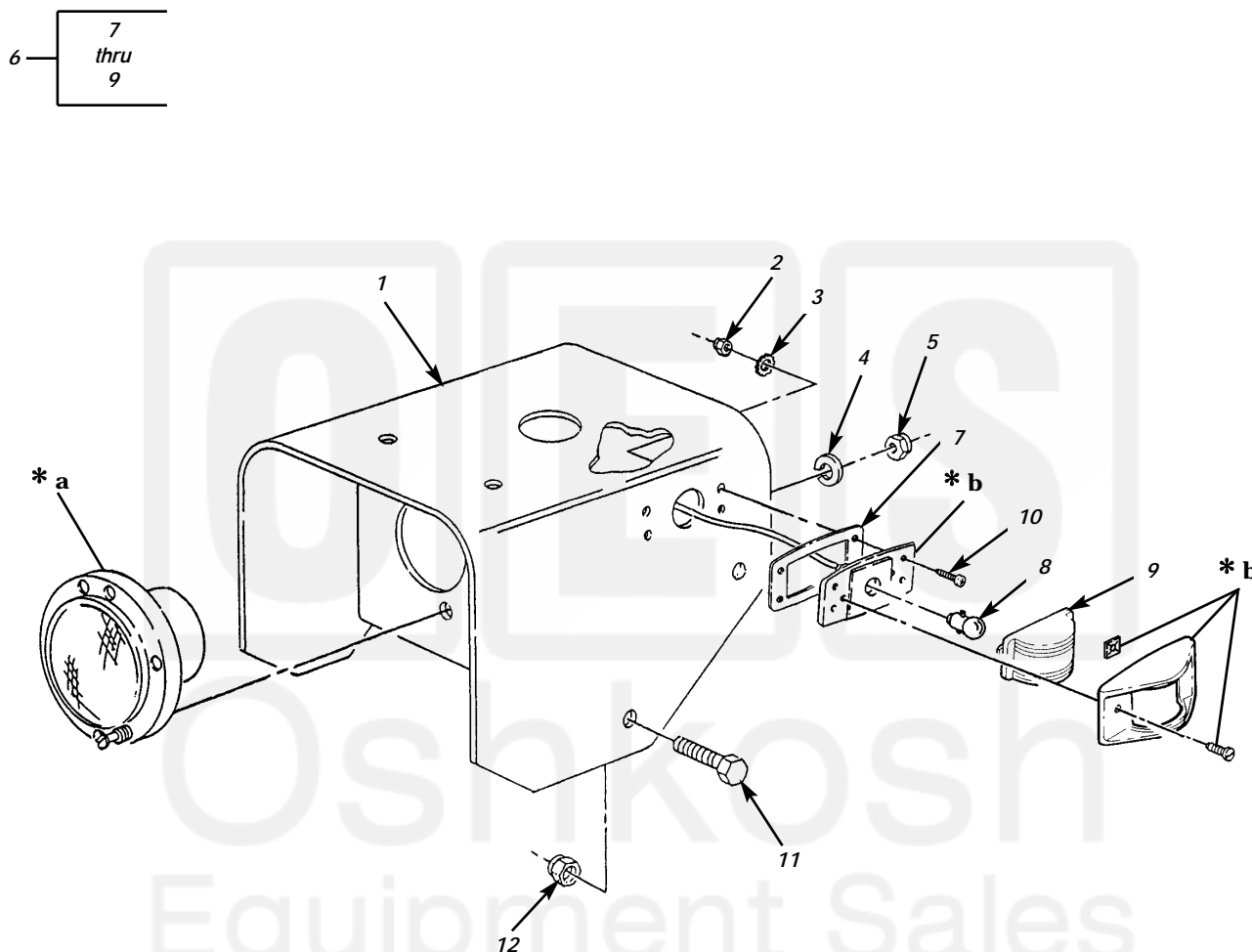

* a FOR BREAKDOWN SEE TM 9-2320-361-20P

* b PART OF ITEM 6

Figure 59. Headlamp, Front Side Marker, and Mounting Bracket.

TM9-2320-386-24P					0060 00	
(1)	(2)	(3)	(4)	(5)	(6)	(7)
ITEM	SMR			PART		
NO	CODE	NSN	CAGEC	NUMBER	DESCRIPTION AND USABLE ON CODES(UOC)	QTY
GROUP 0609 LIGHTS						
FIG. 59 HEADLAMP,FRONT SIDE MARKER, AND MOUNTING BRACKET						
1	PAOZZ	5340014076225	19207	12448988	BRACKET,MOUNTING L.H.....	1
1	PAOZZ	5340014076230	19207	12448989	BRACKET,MOUNTING R.H.....	1
2	PAOZZ	5310002514503	24617	9411893	NUT,LOCK.....	8
3	PAOZZ	5310008892769	96906	MS45904-61	WASHER,LOCK.....	2
4	PAOZZ	5310005825965	96906	MS35338-44	WASHER,LOCK.....	6
5	PAOZZ	5310007680319	96906	MS51968-2	NUT,PLAIN,HEXAGON.....	6
6	PAOOO	6220005773434	96906	MS35423-1	LIGHT,MARKER,CLEARA.....	2
7	PAOZZ	5330003530959	73331	5939841	.FELT,MECHANICAL,PRE.....	1
8	PAOZZ	6240000190877	46717	LA-361-9	.LAMP,INCANDESCENT.....	1
9	PAOZZ	6220002997425	96906	MS35421-1	.LENS,LIGHT.....	1
10	PAOZZ	5305011858647	11862	160057	SCREW,MACHINE.....	8
11	PAOZZ	5305011409118	80204	B1821BH038C088N	SCREW,CAP,HEXAGON H.....	8
12	PAOZZ	5310004582382	24617	9418969	NUT,SELF-LOCKING,HE.....	8

END OF FIGURE